

# LA-SPOT15

## Wireless Loudspeaker

# User Manual

### Specifications

**Type:** Powered wireless coaxial loudspeaker

**Tweeter:** 0.5"

**Woofers:** 5"

**RMS power:** 15W

**Sensitivity** (1W/1m): 90dB

**Frequency response:** 90Hz-20kHz

**Broadcast receive sensitivity** (Conduction): -95dB

**Power supply:** 100-250VAC/50-60Hz

**Stand power:** 0.7W

**Dimensions** (HxWxD): 136x136x157.2mm (without mounting bracket and track)

**Weight:** 1.6kg

**Construction:** Aluminum

**Front finish:** Powder coated aluminum grill with lining

**Bracket:** Powder coated steel

**Accessories included:** mounting bracket, power cable, electrical appliances for guide rail

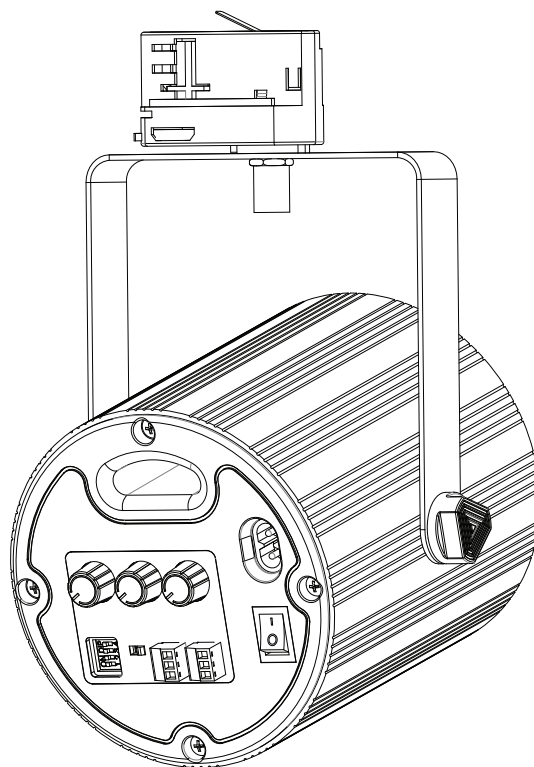

### Wireless Features

Built-in 2.4GHz Bluetooth receiver

Wireless full CD audio quality

No interference or delays

4-bit addressing dip switch (channel switching)

**Range:** 20-30m depending on conditions

Wired option with balanced in/outputs

### Track Adapter

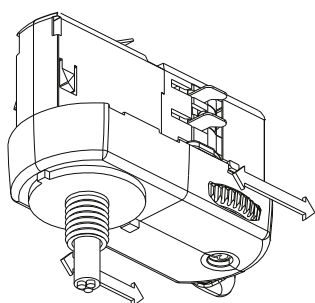

Choose the phase (1, 2, or 3) before fastening into the track or afterwards.

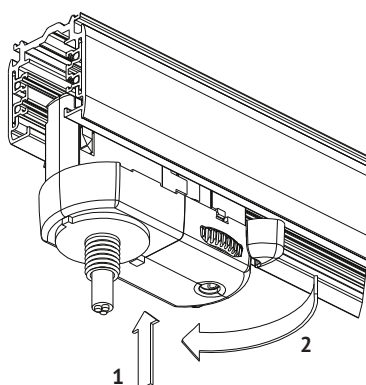

Fastening of the adapter

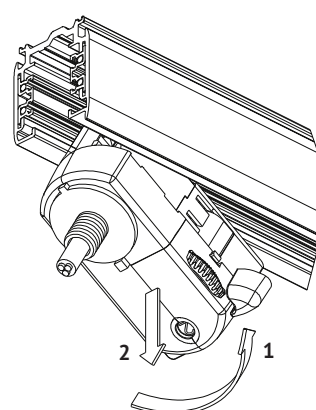

Removing the adapter



The lightning flash with arrowhead symbol, within an equilateral triangle, is intended to alert the user to the presence of uninsulated “dangerous voltage” within the product’s enclosure that may be of sufficient magnitude to constitute a risk of electric shock to persons.



The exclamation point within an equilateral triangle is intended to alert the user to the presence of important operating and maintenance (servicing) instructions in the literature accompanying the appliance

#### **WARNING:**

TO REDUCE THE RISK OF FIRE OR ELECTRIC SHOCK, DO NOT EXPOSE THIS APPLIANCE TO RAIN OR MOISTURE.

#### **CAUTION:**

TO REDUCE THE RISK OF ELECTRIC SHOCK, DO NOT REMOVE COVER (OR BACK). NO USER-SERVICEABLE PARTS INSIDE. REFER SERVICING TO QUALIFIED SERVICE PERSONNEL.

### **IMPORTANT SAFETY INSTRUCTIONS**

1. Read these instructions.
  2. Keep these instructions.
  3. Heed all warnings.
  4. Follow all instructions.
  5. Do not use this appliance near water.
  6. Clean only with dry cloth.
  7. Do not block any ventilation openings. Install in accordance with the manufacturer’s instructions.
  8. Do not install near any heat sources such as radiators, heat registers, stoves, or other apparatus (including amplifiers) that produce heat.
  9. Protect the power cord from being walked on or pinched particularly at plugs, convenience receptacles, and the point where they exit from the appliance.
  10. Only use attachments/accessories specified by the manufacturer.
  11. Unplug this appliance during lightning storms or when unused for long periods of time.
  12. Refer all servicing to qualified service personnel. Servicing is required when the appliance has been damaged in any way, such as power-supply cord or plug is damaged, liquid has been spilled or objects have fallen into the appliance, the appliance has been exposed to rain or moisture, does not operate normally, or has been dropped.
  13. Damage Requiring Service  
Unplug the appliance from the wall outlet and refer servicing to qualified service personnel under the following conditions:
    - A. When the power-supply cord or plug is damaged,
    - B. If liquid has been spilled, or objects have fallen into the appliance,
    - C. If the appliance has been exposed to rain or water,
    - D. If the appliance does not operate normally by following the operating instructions. Adjust only those controls that are covered by the operating instructions as an improper adjustment of other controls may result in damage and will often require extensive work by a qualified technician to restore the appliance to its normal operation,
    - E. If the appliance has been dropped or damaged in any way, and
    - F. When the appliance exhibits a distinct change in performance this indicates a need for service.
  14. Object and Liquid Entry  
Never push objects of any kind into the appliance through openings as they may touch dangerous voltage points or short-out parts that could result in a fire or electric shock. The appliance shall not be exposed to dripping or splashing and no objects filled with liquids, such as vases shall be placed on the appliance. Don’t put candles or other burning objects on top of this unit.
  15. Batteries  
Always consider the environmental issues and follow local regulations when disposing of batteries.
  16. The power supply and power cord for this appliance is intended for indoor use only.
- WHERE THE MAINS PLUG OR AN APPLIANCE COUPLER IS USED AS THE DISCONNECT DEVICE, THE DISCONNECT DEVICE SHALL REMAIN READILY OPERABLE.

## PRODUCT OVERVIEW

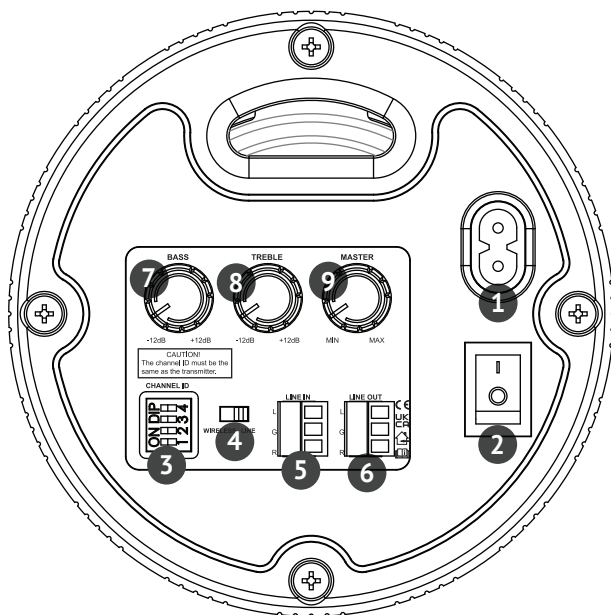

### REAR

#### 1. Power

Connect to AC outlet 100–250V.

#### 2. ON/OFF

Turn the loudspeaker on or off.

#### 3. 4-bit Addressing Dip Switch

Set speaker channel ID. (Whole system must use the same channel ID as the MPW01W transmitter.)

#### 4. Wireless/Line Switch

Determine which mode the speaker should operate.

#### 5. Line In

Connect from “Line Out” on other speaker with unbalanced cable. (Make sure to switch to Line In Wired audio input, see point 4.)

#### 6. Line Out

Connect to “Line In” on other speaker with unbalanced cable.

#### 7. Bass Control Knob

Adjust the bass level of the speaker.

#### 8. Treble Control Knob

Adjust the treble level of the speaker.

#### 9. Master Volume Control Knob

Adjust the volume of the speaker to desired level.

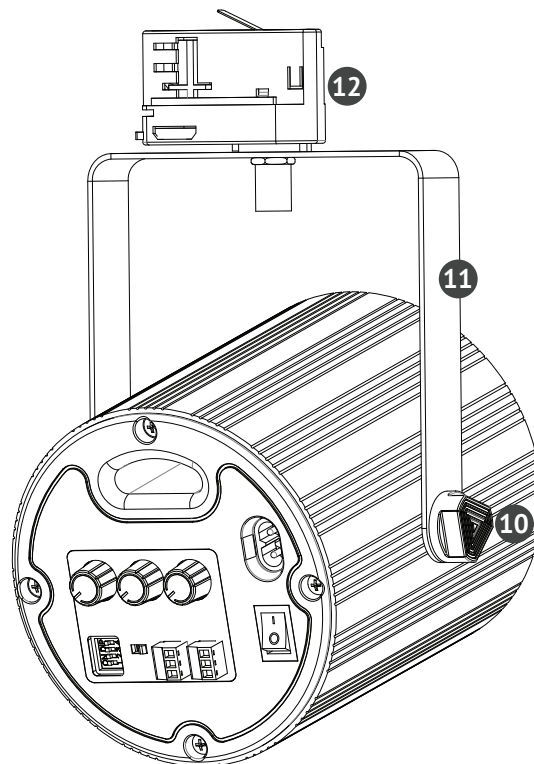

### BRACKET and TRACK ADAPTER

#### 10. Angle Fixing Knob

Adjust the angle of the speaker when installing.

#### 11. Powder Coated Steel Bracket

Bracket of the speaker.

#### 12. Track Adapter

Fasten the speaker to the track.